

**FOR SALE**

**300 SW 17 Ave**  
**MIAMI, FL 33135**



# PROPERTY DESCRIPTION

300 SW 17<sup>TH</sup> AVE, FL 33135

Prime retail space at 300 SW 17th Ave, is a lucrative investment opportunity. The property boasts high ceilings and modern amenities. Property wide renovation completed in 2022, including new electric, plumbing, HVAC and grease trap. Tenants benefit from a recent property-wide renovation, including new AC units and grease traps. With 24-hour access and ample signage potential, this fully occupied property offers immediate returns.

## PROPERTY HIGHLIGHTS

Property Type	Retail, Food & Beverage
Ceiling	17' - 20'
Renovated	2022
Allowable Uses	Commissary Kitchen, Ghost Kitchens, Food Production Facilities
Asking Price	\$3,500,000

Adress	NOI	CAP Rate
300 SW 17 <sup>th</sup> Ave	\$221,000	6.33%



This information has been obtained from sources believed reliable. We have not verified it and make no guarantee, warranty or representation about it. ©2024 APEX CAPITAL REALTY LLC.

MIGUEL PINTO | CEO/FOUNDER | 305 570-2600

# FLOOR PLAN

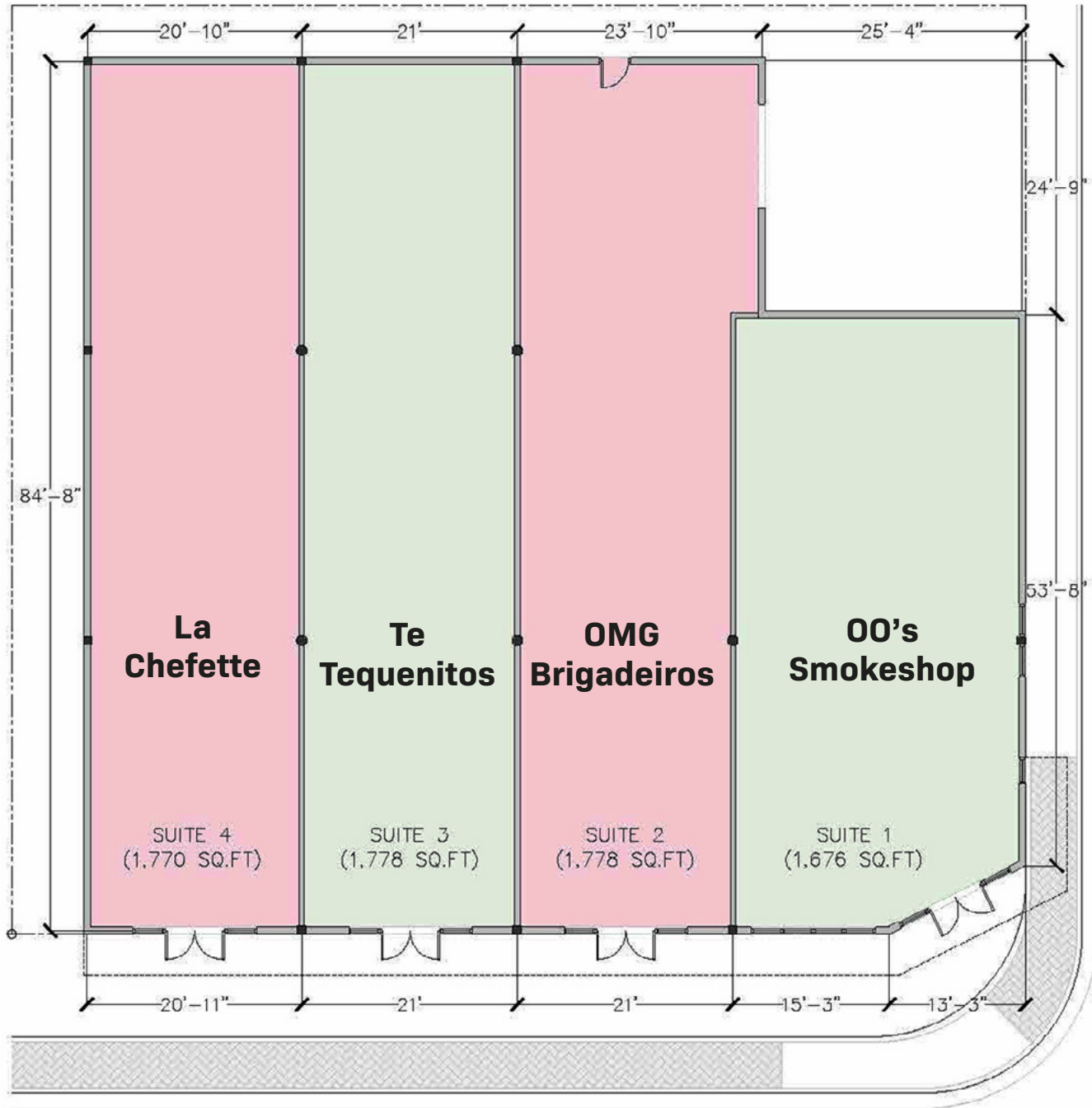

# SUITE 2 INTERIOR PHOTOS



# SUITE 3 INTERIOR PHOTOS



# SOUTH WEST VIEW

Coconut Grove  
3 MILES

Coral Gables  
3 MILES

CALLE OCHO

CALLE OCHO

CALLE OCHO

SW 17 AVE

SW 17 AVE

SUBJECT  
SITE



This information has been obtained from sources believed reliable. We have not verified it and make no guarantee, warranty or representation about it. ©2024 APEX CAPITAL REALTY LLC.

MIGUEL PINTO | CEO/FOUNDER | 305 570-2600

# EAST VIEW

Downtown Miami  
2 MILES

Brickell  
2 MILES

SW 17 AVE

SUBJECT  
SITE

SW 17 AVE

# LOCATION MAP



**MARLINS PARK**

**Sedano's**

**WEST FLAGLER STREET**

**WEST FLAGLER STREET**

**WEST FLAGLER STREET**

**Publix**  
SUPERMARKET  
AT ALTOS PLAZA

**SUBJECT PROPERTY**

**CHASE**

**Miami Dade College**  
Padrón Campus

**PRESIDENTE**  
SUPERMARKET

**WELLS FARGO**

**EL SANTO**  
CANTINA

**BALL & CHAN**

**LA TERRAZZA**

**DOMINO PARK**

**CHURRO MANTA**

**CUBAOCHO**  
CULTURE & PERFORMING ARTS CENTER

**CALLE OCHO**

**CALLE OCHO**

**APEX**  
CAPITAL REALTY

This information has been obtained from sources believed reliable. We have not verified it and make no guarantee, warranty or representation about it. ©2024 APEX CAPITAL REALTY LLC.

MIGUEL PINTO | CEO/FOUNDER | 305 570-2600



# CONTACT US

**MIGUEL PINTO**

CEO/FOUNDER

(305) 570-2600

[MIGUEL@APEXCAPITALREALTY.COM](mailto:MIGUEL@APEXCAPITALREALTY.COM)

[APEXCAPITALREALTY.COM](http://APEXCAPITALREALTY.COM)



**APEX**  
CAPITAL REALTY